

# CONNECTING ROD

The Oregon SAE Newsletter

June 2005 Volume 10 issue 1

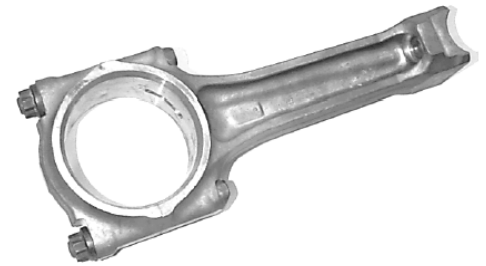

Online at: [www.oregonsae.org](http://www.oregonsae.org)

## June 6<sup>th</sup>, Oregon SAE Board Meeting, 5:30 PM

Location: Freightliner, Corp 1. 4747 N. Channel Ave, Portland, OR.

Quarterly, long format meeting. Pizza will be served, please RSVP to George Gvakharia. (503)-745-5975 or email [GeorgeGvakharia@Freightliner.com](mailto:GeorgeGvakharia@Freightliner.com)

## June 10<sup>th</sup>, Friday Lunch Meeting, 11:45 AM – Details on page 3

Topic: Professional Services Industries Testing Laboratory.

**RSVP by June 8, 2005.**

## June 16<sup>th</sup>, Championship Auto Racing Cars (CHAMP), 11:45 AM

A behind-the-scenes meeting prior to the CHAMP Car Race at Portland International Raceway. Details on page 2.

## Oregon SAE Wins Section Gold Award of Excellence for 2003-'04.

SAE National has once again recognized the Oregon Section with the Gold Award of Excellence for 2003-2004. This is the fifth consecutive year OSAE has achieved Gold status. This award is achieved by only a few Sections. Thanks to all who contributed their time and effort.

## Oregon SAE

### Section Officers, 2005-06

Chairman:	George Gvakharia	(503) 745-5975	<a href="mailto:GeorgeGvakharia@Freightliner.com">GeorgeGvakharia@Freightliner.com</a>
Treasurer	Paul Labberton	(503) 745-7451	<a href="mailto:PaulLabberton@Freightliner.com">PaulLabberton@Freightliner.com</a>
Secretary:	Steven Thorud	(971)-409-6212	<a href="mailto:stephen.thorud@gmail.com">stephen.thorud@gmail.com</a>
Tech Mtg Coord:	Andre Susanto	(503) 318-2547	<a href="mailto:susantoa1@asme.org">susantoa1@asme.org</a>
Lunch Mtg Coordinator:	Ben Hansen	(503) 745-6041	<a href="mailto:BenjaminHansen@Freightliner.com">BenjaminHansen@Freightliner.com</a>
VC Student Activities / Scholarship:	Vaughn Hultsman	(503)-721-6909	<a href="mailto:cpvhults@nmhg.com">cpvhults@nmhg.com</a>
VC Motorsports	Vijay Gopalswamy	(503)-745-8749	<a href="mailto:VijayKGS@Freightliner.com">VijayKGS@Freightliner.com</a>
VC Membership / Company Rep:	Mike Eagan	(503) 297-2776	<a href="mailto:Mike@GNFreund.com">Mike@GNFreund.com</a>
VC SPA Fund:	George Freund	(503) 297-2776	<a href="mailto:George@GNFreund.com">George@GNFreund.com</a>
Delegate ANC:	Ryan Jefferis	(503) 745-6361	<a href="mailto:RyanJefferis@Freightliner.com">RyanJefferis@Freightliner.com</a>
First Alternate:	George Freund	(503) 297-2776	<a href="mailto:George@GNFreund.com">George@GNFreund.com</a>
Webmaster:	Andre Susanto	(503) 318-2547	<a href="mailto:susantoa1@asme.org">susantoa1@asme.org</a>
Newsletter Editor:	Jim Turney	(503) 745-5548	<a href="mailto:JamesTurney@Freightliner.com">JamesTurney@Freightliner.com</a>

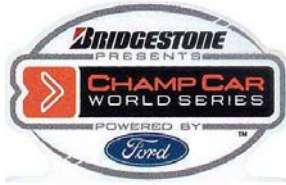

## A unique opportunity for a behind the scenes look at Champ Car racing.

[www.champcarworldseries.com](http://www.champcarworldseries.com)

***Bring in your questions that you always wanted to ask a race car engineer, engine specialist or a professional driver.***

The visit includes:

- Team Garage Tour ([PKV Racing](#)) : Discussion on chassis, race car, team set-up etc
- Q & A with Cosworth Race Engine Specialist.
- Pit / Technical Inspection area tour.

***When:*** Thursday, 16<sup>th</sup> June 2005.

11:45 – 12:45 pm: No host Lunch at *Burrito House, 1220 N Hayden Meadows Drive.*

12:45 – 1:00 pm: Drive to PIR.

1:00 – 3:30 pm: Tour and Q & A.

***Where:*** In-field of Portland International Raceway (PIR)

***Price:*** Free for SAE Members and their family, \$10 for non-members.

**Space is limited, RSVP** to [VijayGopalswamy@Freightliner.com](mailto:VijayGopalswamy@Freightliner.com) to reserve your spot.

(SAE Members please mention your membership number)



# Lunch Meeting at Professional Services Industries (PSI)



It's safe to say that engineering without testing can produce unwanted results. So who makes sure that the products we use perform correctly, are in suitable condition for use, and are safe? Professional Service Industries, Inc. for one. Whatever part of the mobility market you may be involved in, this Presentation and Tour at PSI is sure to be of interest. Bring your appetite and test questions to the SAE Lunch meeting on Friday, June 10<sup>th</sup>, at 11:45 am.

PSI does both in-house and on-site testing for a variety of industries. In-housing testing includes environmental exposure, cyclic testing, custom testing, magnetic particle testing, strain analysis and ultimate load test (for example: Maximum load of rebar, or tensile testing of fasteners). The list of possible test is too long to publish, so a review at the meeting will be done. On-site testing will also be briefly reviewed.



If you have safety glasses, please bring them so there are enough to go around. Demonstrations are planned!

**For a lunch count please RSVP by June 8th to [mike@gnfreund.com](mailto:mike@gnfreund.com) or (503)-297-2776**

**Location:** PSI Testing Laboratory  
6032 N. Cutter Circle, Suite 480  
Portland, Oregon (Swan Island)

**Price:** \$8.00 (Box Lunch - please specify if vegetarian is needed)

