

# CONNECTING ROD

The Oregon SAE Newsletter

December 2004 Volume 9 issue 7



Online at: [www.oregonsae.org](http://www.oregonsae.org)

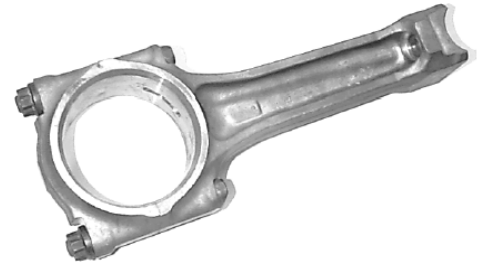

## December 1st Oregon SAE Governing Board, 5:30-6:00PM

Location: Freightliner Corp 1. 4747 N. Channel Ave, Portland, OR.

## January 12<sup>th</sup> Oregon SAE Governing Board meeting, 5:30-7:30PM

Location: Freightliner, Corp 1. 4747 N. Channel Ave, Portland, OR.

Quarterly 'long format' meeting. Pizza served – RSVP to Jim Turney.

## December 11th (Saturday) Winter Social 4:00 PM

Location: Old Spaghetti Factory, Clackamas, OR

- Celebrate Oregon SAE 75<sup>th</sup> Anniversary
- Past Chairman will be recognized at the Winter Social this year. We are collecting a history of the Section through our Past Chairmen that can be preserved for posterity.
- Learn the history of the 'infamous' TP Fund and how it's used to support Section Activities.
- RSVP required

## Section Officers, 2004-05

Chairman:	Jim Turney	(503) 745-5548	<a href="mailto:JamesTurney@Freightliner.com">JamesTurney@Freightliner.com</a>
Treasurer	Quinn Collett	(503)-745-7654	<a href="mailto:QuinnCollett@Freightliner.com">QuinnCollett@Freightliner.com</a>
Secretary:	Andre Susanto	(503) 318-2547	<a href="mailto:susantoa1@asme.org">susantoa1@asme.org</a>
VC Membership / Company Rep:	Jason Wilkening	(503) 745-9071	<a href="mailto:JasonWilkening@Freightliner.com">JasonWilkening@Freightliner.com</a>
Tech Mtg Coord:	George Gvakharia	(503) 745-5975	<a href="mailto:GeorgeGvakharia@Freightliner.com">GeorgeGvakharia@Freightliner.com</a>
Lunch Mtg Coordinator:	Paul Labberton	(503) 745-7451	<a href="mailto:PaulLabberton@Freightliner.com">PaulLabberton@Freightliner.com</a>
VC Student Activities / Scholarship:	Ben Hansen	(503) 745-6041	<a href="mailto:BenjaminHansen@Freightliner.com">BenjaminHansen@Freightliner.com</a>
Co-VC Math/Science / AWIM:	Gregg Woods	(503) 297-2776	<a href="mailto:Gregg@GNFreund.com">Gregg@GNFreund.com</a>
Co-VC Math/Science / AWIM:	Andre Susanto	(503) 318-2547	<a href="mailto:susantoa1@asme.org">susantoa1@asme.org</a>
VC SPA Fund:	George Freund	(503) 297-2776	<a href="mailto:George@GNFreund.com">George@GNFreund.com</a>
Delegate ANC:	Ryan Jefferis	(503) 745-6361	<a href="mailto:RyanJefferis@Freightliner.com">RyanJefferis@Freightliner.com</a>
First Alternate:	George Freund	(503) 297-2776	<a href="mailto:George@GNFreund.com">George@GNFreund.com</a>
Webmaster:	Andre Susanto	(503) 318-2547	<a href="mailto:susantoa1@asme.org">susantoa1@asme.org</a>
Newsletter Editor:	Mike Eagan	(503) 297-2776	<a href="mailto:Mike@GNFreund.com">Mike@GNFreund.com</a>
National AWIM Committee:	Betty Kendall	(503) 223-0016	<a href="mailto:BettyKendall@aol.com">BettyKendall@aol.com</a>

MERRY CHRISTMAS AND A HAPPY NEW YEAR!!!

Paid Advertisement



**Schaefer Engineering Corporation is currently seeking highly qualified and experienced individuals to join our forensic engineering staff in the Portland, Oregon office.**

### **Engineer/Vehicle Accident Reconstructionist (AR)**

**Immediate opening for a licensed engineer with training and/or experience in vehicle accident reconstruction.** ACTAR or equivalently qualified/certified individual preferred. The primary focus of the position will be to direct and conduct investigations to determine the cause and nature of vehicle collisions/accidents and mechanical failures. Position includes both office and field duties. Ideal candidate has a history of successful court and deposition appearances, as well as a proficiency in A.R. software applications. Candidate must have minimum five years work experience in low-impact analysis, heavy equipment, supplemental restraint systems and/or other specialty. Salary DOE. Full benefits package including 401k/pension. Schaefer Engineering is an established forensic engineering firm with a history of sustained growth and excellent customer service. Please contact Anna Klostermann via email; [aklostermann@forensic-engrs.com](mailto:aklostermann@forensic-engrs.com)

Please visit Schaefer Engineering's web site at [www.forensic-engrs.com](http://www.forensic-engrs.com) for additional information.

Equal Opportunity Employer

Seattle, WA • Portland, OR • Denver, CO

### **Special Thanks to Stack Metallurgical**

Oregon SAE gives a big "Thank You" to Stack Metallurgical for covering the cost of the lunches at the November 11<sup>th</sup> Lunch. This unexpected surprise will help Oregon SAE support this year's activities including Student Competitions in Formula and Mini Baja teams. By the way, the box lunches were very good.

Induction heat treating up to 350 lb., 16" diameter x 46" long. Custom inductor coils can be fabricated on site.



### **Collegiate Design Team Notice**

The November edition of 'Collegiate Design Series News' Student Newsletter Online is now available at <http://students.sae.org/competitions/newsletters>

*Oregon SAE presents:*

## *2004 Winter Social Event*

### **“Oregon SAE 75<sup>th</sup> Anniversary – Honoring our History”**

Coinciding with the SAE centennial, Oregon SAE is also celebrating 75 years of achievement. To commemorate this special anniversary, we are recognizing the Past Chairmen of our section at the Winter Social. Past chairs are encouraged to send a paragraph on their year(s) at the helm of Oregon SAE, including any significant historical events, to Ryan Jefferis (contact info below). The information will be compiled and presented at the social, and used as an ongoing history of our section.



- When:** Saturday December 11<sup>th</sup> @ 4 pm
- Where:** The Old Spaghetti Factory  
12725 S.E. 93rd Ave  
Clackamas, OR 97015
- Info:** \$15 per person (adults only please)  
Includes salad, entrée, dessert, & beverage  
Spouses/guests are welcome!  
**Reservations due Tuesday, December 7<sup>th</sup>**

*To make a reservation, send a check to:*

Ryan Jefferis  
FTH-CAE  
c/o Freightliner LLC  
4435 N. Channel Ave  
Portland, OR 97217  
(503) 745-6361  
ryanjefferis@freightliner.com

Make checks payable to **Oregon SAE**

*Directions:*

The Old Spaghetti Factory is just south of Sunnyside Rd off I-205, across from Clackamas Town Center

